

Prolite™

www.prolite.co.nz www.prolitemarine.com

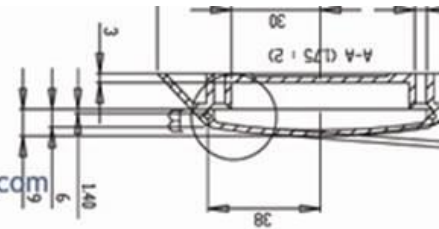

BETA 3PIN PLUGS & CORD CONNECTORS

Features:

#15114.1

Heavy Duty .75 to 2.5mm² Insulated round flex. 230-240v, 10 Amp Max or **NEW** 15 Amp Max.

Moulded rubber, flexible and shock absorbing.

Benefits:

Less parts, easy and quick to assemble
Patented cord grip, no fiddly screws. Engineered non-slip.

SHOCK RESISTANT

DISABILITY FRIENDLY

ASSEMBLY FRIENDLY

SAFE, UNBREAKABLE

COMMERCIAL

INDUSTRIAL

DOMESTIC

Individually packed with

Barcodes and instructions.



Range:

3 Pin Plugs & Cord Connectors, 10 Amp. Black (standard). code- BETA3PIN PLUG & BETACORDCONN

Clear code- BETA3PINCL & BETACORDCONNCL

3 pin plug 15A Black (standard) code- BETA15APLUG, Clear, code- BETA15ACL

Clear front and rear (CL): allows visual verification of matching conductors (blue to blue etc). Saves time in testing and tagging procedure.

Couplings to enable BETA products driving rain proof - IP56.

Code- BETAPLCOUP for Plug, code BETACOCOUP for Cord Connector.

For use on BETA product only, but is a compatible fit with other brands of IP56 equipment:

i.e.: Beta Plug and plug coupling fits ALL brands of IP56 connectors or sockets.

i.e.: Beta Cord Connector and connector coupling fits ALL brands of IP56 plugs.

Orange as standard.

Warranty: 5 years.

PATENT 335172 Z50 COPYRIGHT **MADE IN NEW ZEALAND**

Compliance: AS/NZS 3112. AS/NZS 3820. Authorized test laboratory certified.

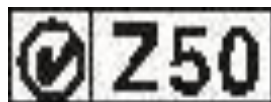

Prolite Lighting. 21 McMaster St. Greytown. New Zealand 5712. +64 6 304 7111. Fax +64 6 304 7213

tomkies@hotmail.co.nz

Agents, distributors and manufacturers.