

Prolite™

www.prolite.co.nz www.prolitemarine.com

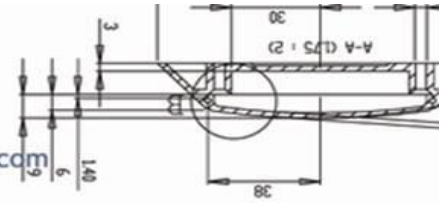

PROLITE SOFFIT LED 9-30vDC INDOOR/ OUTDOOR LIGHT.

Doc#10115.1

Equivalent to 20W 12v Halogen Dichroic- perfect for soffit, under cupboard, marine, motor home.

Features (LED the way to \$mart)

- Water resistant, IP44 when installed on a ceiling surface. Only 100mm diameter x 8mm.
- 50,000 hour approx equal to 40 incandescent lamp lives.
- High Bright 5630 SMD LED chips.
- Colour- warm white 3,000K. Viewing angle: 38 degree.
- Available in square 316 SS, with or without eyelid (black) and round with eyelid.
- Equivalent to 20W 12v Halogen Dichroic- perfect for soffit, under cupboard, marine, motor home



- Anodised aluminium, matt silver, and UV resistant polymer.
- Instant start, non flicker and shock resistant.

Benefits (LED the way to \$mart)

- Reliable, long life.
- Energy efficient, low running cost
- Multi units per driver- drivers are extra.
- UV resistant, salt resistant.
- SURFACE FITTING-No ceiling penetration, except cable, retains thermal factor.
- Quick to install, two screws behind removable diffuser.
- Multiple units in parallel from 12 or 24v DC driver.



Range (LED the way to \$mart)

- SLLED3 Round 9-30vDC 3W WW LED 260LM
- SLEDE3 Above with Black Nylon Eyelid
- SSLLED3SS Round-matt silver body, Square-316 SS Face plate
- SSLEDE3SS Above square with Black Nylon Eyelid
- 110-230v to 12vDC drivers available, IP20 or IP66.

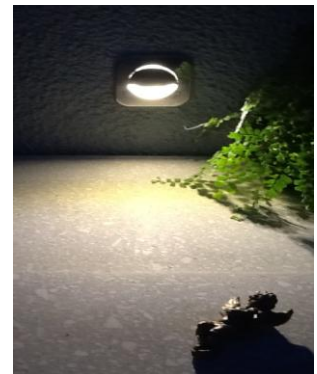

Warranty

- Warranted 5 years. Lamp life- >50,000 hours.
- Warranty limited to repair or replacement of SOFFIT LIGHT only.

INDOOR or OUTDOOR.

Compliance: AS/NZS61046. AS/NZS3820

